

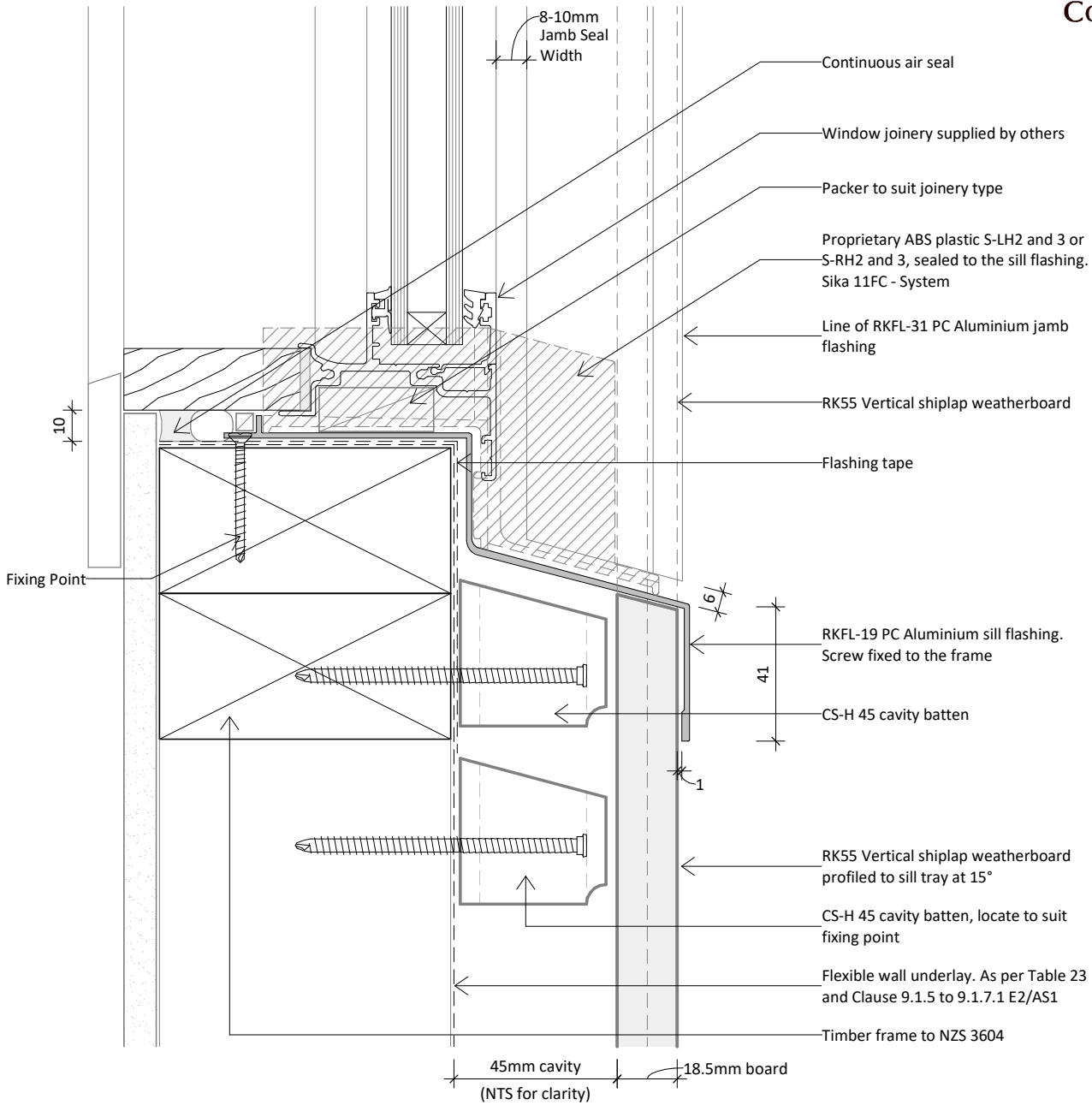

CODEMARK[™]
CM70082



interactive assembly instructions available

<http://wksp.nz/rki-rwf-wf3>



Get **WORKINGSPEC** from Apple App Store/Google Play

1. Scope as per Clauses 1.0 and 9.4 E2/AS1
2. Compatibility of materials as per Tables 20-22 E2/AS1
3. The flashing system relies upon the joinery meeting the requirements of NZS 4211 and for the relevant building wind pressures
4. INTERSET flashings are designed exclusively for use with the Rosenfeld Kidson Cedarscreen Vertical 45mm system
5. Windows to have a 10mm perimeter clearance for application of a continuous air seal
6. Non-exposed flashings powdercoated in Duralloy. Exposed flashings powdercoated in Duratec
7. Cavity Batten System in-line with Cedarscreen 45mm Vertical System

INTERSET
RECESSED WINDOWS FOR TIMBER CLADDING

www.rosenfeldkidson.co.nz
www.cedarscreen.co.nz

Postal Address: P O Box 621,
Shortland Street, Auckland 1140

Auckland Branch:
T: +64 9 573 0503
F: +64 9 573 0504
513 Mount Wellington Highway
Mount Wellington, Auckland 1060

Christchurch Branch:
T: +64 3 349 3316
F: +64 3 349 3317
15 Edmonton Road
Hornby, Christchurch 8042

Title **Window Sill Detail**

Drawing

RK-FU-21

Scale 1 : 2 @ A4

Date 14.10.2020